



CITY OF PORTLAND ENVIRONMENTAL SERVICES



1120 SW Fifth Avenue, Room 400, Portland, Oregon 97204-1972

(503) 823-7740, FAX (503) 823-6995

Dean Marriott, Director

February 13, 1997

Dear Friend of Russell Pond:

The site design concept you helped develop has been moved forward to the engineers for evaluation. On November 9, 1996, many of us joined at Madison High school to create our joint vision of what the Russell Pond Site at NE 89th and Fremont Drive should look like. The input used from the small groups at the design charette, as well as other input gained from phone calls from other neighbors and interested parties, has been gathered together over the last few months and combined into the attached site concept plan. This plan takes something from everyone's ideas and tries to combine them into one concept. What do you think of the result?

This plan has been forwarded to the design engineers here at the Bureau. They will begin their evaluation of the redesign of the fenced-in area around Russell Pond. All our goals are listed on the left side of the design plan concept so we can make sure that any final plan considers these objectives.

I hope this plan helps to visualize your ideas for the site. If not, please let me know what seems out of line with the discussions we had last year. From here the engineers will take another few months of study to address the hydrology of the site, and then will begin to prepare an initial site design. Then the project goes in for budget consideration. If all goes well we will be back in June with the next generation of plans to show you. If you have questions between now and then or can think of anyone else to add to my contact list, please let me know. I can be reached at 823-7767, Monday through Thursday.

Thanks again for your aide and your interest in this unique community resource.

Sincerely,

Dawn C. Hottenroth
Environmental Specialist

CC: Files (BES & WCC)



CITY OF PORTLAND ENVIRONMENTAL SERVICES



1211 SW Fifth Avenue, Room 800, Portland, Oregon 97204-3713

(503) 823-7740, FAX (503) 823-6995

Dean Marriott, Director

April 15, 1999

Dear Friend of Russell Pond:

I am pleased to announce the Bureau of Environmental Services has completed the draft plan design for the retrofit project at the Russell Detention pond site at 89th and Fremont. This project, scheduled for late this fall, will enhance the water quality function of the Russell Detention Pond and will meet other environmental and community goals for site use. The project design incorporates many of the ideas and goals generated by a design brainstorming meeting two years ago with local neighbors and Madison High School students. The project has two major components; enhancement of the water quality function of the stormwater facility, and placement of a permanent vegetation scheme.

Environmental Services will "daylight" a major stormwater drainage pipe that currently goes into the pond. The daylighting will bring currently piped water to the surface and direct its flow into a vegetated swale that will filter sediment and other pollutants out of the stormwater runoff before it reaches the pond. This swale will improve the water quality of the runoff entering the pond. In addition, the pond will be enlarged slightly to handle flows from any development directly within the existing Russell basin (the southern basin that flows toward the pond). Overall, this portion of the project will meet the stormwater goals and enhance habitat values of the entire site.

The permanent vegetation scheme is still under development, but will be based on the community site concept plan developed two years ago (see enclosure). We are still working out which elements need to be modified by the swale flow paths. In general, the goal of the new plant regime is to replace the annual wildflower seeding with a permanent installation of native plants in natural plant communities. These natives will require very little or no use of herbicides and will need less maintenance over time than the current site plantings. In addition, natives will greatly enhance the site's habitat values for local birds and animals.

The remaining work for Environmental Services and the community is to decide how to use the site and how accessible it will be. Possibilities include making it a nature park, or keeping it fenced. There are benefits and drawbacks to any form of site use. What do you think? Please help us out by reviewing the chart on the reverse side of this letter, and by answering the questions on the enclosed survey card and returning it to me.

Thanks again for your interest in this unique community benefit.

Sincerely,

Dawn C. Hottenroth,
Project Manager, 823-7767

PUBLIC ACCESS ALTERNATIVES FOR RUSSELL POND

Community access has long been an issue for the Russell Detention Pond site. Once a natural seep, this pond has been excavated and reengineered many times over the last 50 years. It is our intention for this project to be one that endures for a long time to come.

Russell pond is a unique water quality site within the City of Portland. While providing some limited pollution removal, sediment capture and water infiltration, the site has also developed over the years into a productive seasonal wetland. Over 40 bird species have been known to use the site.

The main question we want to pose to the community is how much site access do you want? There are various options, each with their pros and cons. After using this as a work sheet please send us your ideas on the post card enclosed.

Access Idea	Pros	Cons	Comments Optional RATE 1 - 5 1 = worst choice 5 = best choice
A. Keep the status quo fenced area, allowing only student outdoor education access	<ul style="list-style-type: none"> ▪ Best Habitat Protection ▪ No Cost 	<ul style="list-style-type: none"> ▪ No entry for animals ▪ Aesthetics of ugly fencing 	
B. Keep fence and assign a site steward who controls entry for the community	<ul style="list-style-type: none"> ▪ Some Community Use ▪ Community Controlled Access ▪ Some Habitat Protection ▪ No Real Cost 	<ul style="list-style-type: none"> ▪ Problem Finding Individual or Group ▪ No entry for animals ▪ Aesthetics of ugly fencing 	
C. Keep fenced, but have some partial site access by moving fence.	<ul style="list-style-type: none"> ▪ Allowing Partial Use ▪ Enhanced Visual Look ▪ Better Bird Watching ▪ Some Habitat Protection ▪ May be Able to Address Animal Access Issues 	<ul style="list-style-type: none"> ▪ Aesthetics of ugly fencing ▪ Some Cost to Project ▪ New Liability and Maintenance Considerations ▪ Some Habitat Intrusion 	
D. Partially fenced, remove fence along Fremont, provide another entry at the end of Russell Place.	<ul style="list-style-type: none"> ▪ Allows more public access ▪ Improved aesthetics ▪ Some Bird Watching ▪ Some Habitat Protection 	<ul style="list-style-type: none"> ▪ Aesthetics of ugly fencing ▪ Some Cost to Project ▪ Increased Liability and Maintenance Considerations ▪ Increased Habitat Intrusion 	
E. Take the fence down and create a natural park setting with barrier plants near pond.	<ul style="list-style-type: none"> ▪ Best Visual Aesthetics ▪ Best Animal Access ▪ Most Human Use 	<ul style="list-style-type: none"> ▪ Most Habitat Intrusion ▪ Site Fully Accessible to Undesirable Community Activities ▪ New Liability and Maintenance Considerations 	
F. Other:			

NOTE: Not all items represented in this concept plan will be implemented by BES. Some items – paths or structures may be implemented by neighborhood or other community groups.

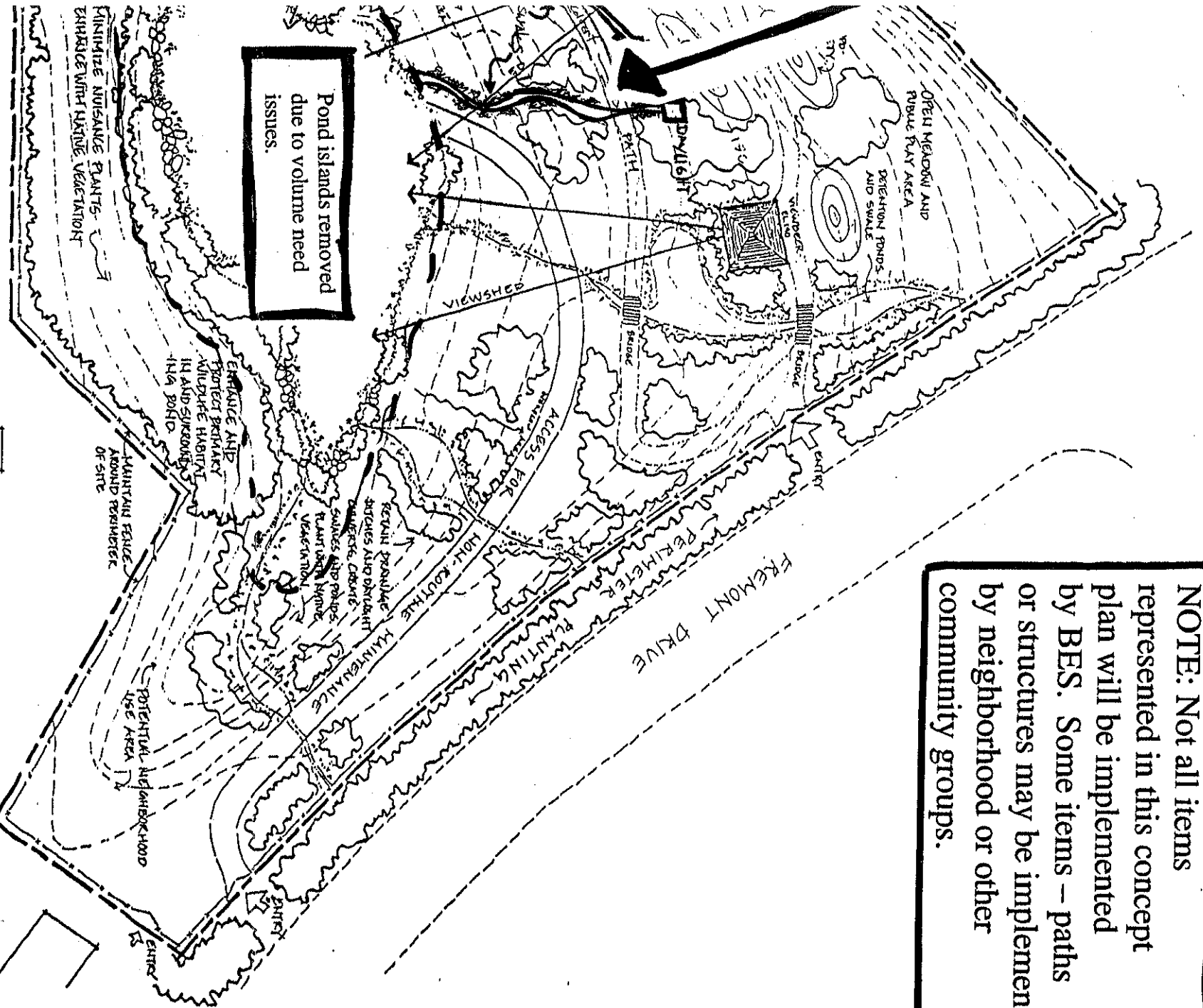

Pond islands removed due to volume need issues.

D CONCEPT PLAN



SCALE: 1"=20'



May James Kelly
 Landscape Architect
 1000 1st Avenue
 Cambridge MA 02142
 617-552-1234

CITY OF PORTLAND, BUREAU OF ENVIRONMENTAL SERVICES
 STORMWATER MANAGEMENT PROGRAM
 MADISON HIGH SCHOOL
 RUSSELL FOND HEIGHTS PARK

JANUARY 1977

WILDLIFE HABITAT GOALS

1. PRESERVE PROTECT AND ENHANCE WILDLIFE HABITAT
2. REMOVE NON-NATIVE NUISANCE PLANTS
3. INCREASE NATIVE PLANTING
4. CREATE PLANTED ISLANDS IN POND

STORMWATER QUALITY GOALS

1. INCREASE STORMWATER RUNOFF CAPACITY
2. IMPROVE ABILITY OF SITE TO CLEAN/FILTER RUNOFF
3. DAYLIGHT RPPS INTO GRASSY SWALES AND PONDS

COMMUNITY GOALS

1. PROVIDE COMMUNITY ACCESS TO SITE
2. PROVIDE VISUAL ACCESS TO POND
3. CREATE VIEW PLATFORMS AND OVERLOOK POINTS WITH INTERPRETIVE DISPLAYS
4. CREATE OTHER ACTIVE PLAY USES
5. CONTINUE SITE AS SCHOOL OUTDOOR EDUCATION AREA

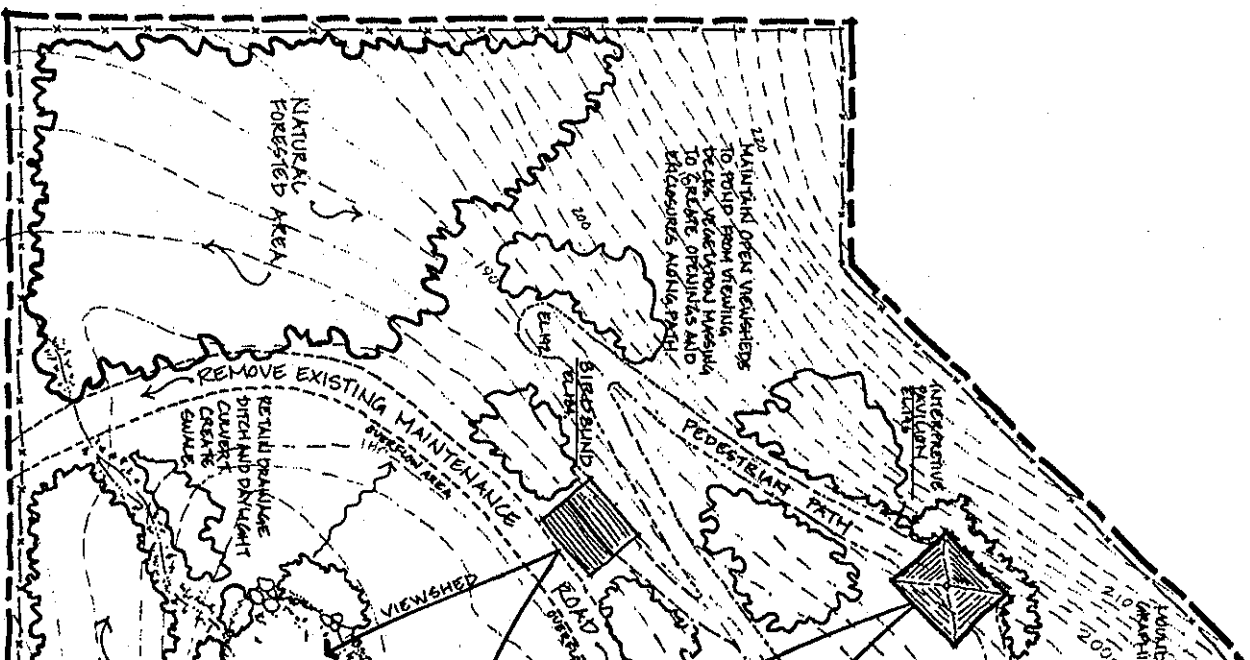

RUSSELL POND

